



GUANNAN CUTTING EDGE



# BULLDOZER CUTTING EDGES (推土机刀片)

件号	尺寸	品牌	型号	净重	尺寸	毛重	材质
PART NUMBER	DESCRIPTION(MM)	BRAND	MODEL	IRWT	IR DES	U' WT(KG)	MATERIAL
8294269	19*203*1060	FIAT				30	30MnB HEAT TREATED
8294669	19*203*756	FIAT				21.3	30MnB HEAT TREATED
8294271	19*203*809	FIAT				22.8	30MnB HEAT TREATED
8294669	19*203*756	FIAT				21.3	30MnB HEAT TREATED
11082664-11	30*480*687	VOLVO				74	30MnB HEAT TREATED
11082666-6	30*380*1818	VOLVO				155	30MnB HEAT TREATED
100-4015	75*380*1190	CAT				272	30MnB HEAT TREATED
100-4043	45*265*556	CAT	CAT980	48.6	45*265*556	48.6	30MnB HEAT TREATED
100-4044	40*200*556	CAT				33.1	30MnB HEAT TREATED
100-6356	45*330*1162	CAT				127.8	30MnB HEAT TREATED
100-6664	30*253*360	CAT		17.9	30*253*360	18.9	30MnB HEAT TREATED
100-6666	30*293*359	CAT	970	21.4	30*293*359	23.4	30MnB HEAT TREATED
100-6668	30*360*1399.5	CAT LOADER	CAT 972	104.7	30*360*1399.5	110	30MnB HEAT TREATED
10120745	30*360*1403.4					110	30MnB HEAT TREATED
10120752	30*360*845					66.5	30MnB HEAT TREATED
10120757	25*280*820					40	30MnB HEAT TREATED

10127292	35*254*806					45.6	30MnB HEAT TREATED
101-9435	38*346*482	CAT	988F	47.5	40*342*482	47.5	30MnB HEAT TREATED
101-9436	38*354*482	CAT	988F	50	40*354*482	50	30MnB HEAT TREATED
101-9437	38*354*482	CAT	988F	50	40*354*482	50	30MnB HEAT TREATED
106-0956	19*254*1380						
106-9290	35*227*510	CAT				28.5	30MnB HEAT TREATED
107-3381	30*360*1240					93.2	30MnB HEAT TREATED
107-3383	75*545*556					165.2	30MnB HEAT TREATED
107-3474	45*254*910					75.65	30MnB HEAT TREATED
107-3477	45*254*1520					127.74	30MnB HEAT TREATED
107-3479	45*254*1034					86.81	30MnB HEAT TREATED
107-3483	45*254*1095					92.12	30MnB HEAT TREATED
107-3490	45*312*482			50	45*312*482	50	30MnB HEAT TREATED
107-3528	45*354*482	CAT				56.3	30MnB HEAT TREATED
107-3537	45*354*482	CAT				56.3	30MnB HEAT TREATED
107-3538	45*354*482					56.3	30MnB HEAT TREATED
107-3746	25*280*1179	CAT LOADER	CAT 938	57	25*280*1179	57	30MnB HEAT TREATED
109-9019	30*315*360			22.3	30*315*360	22.3	30MnB HEAT TREATED
109-9212	35*406*1450	CAT LOADER	CAT 980	153.3	35*406*1450	153.3	30MnB HEAT TREATED
109-9215	35*254*627					41.3	30MnB HEAT TREATED
109-9230	45*406*1451					190.2	30MnB HEAT TREATED
112-2471	45*330*803					88.37	30MnB HEAT TREATED
112-2472	45*330*1353	CAT	D8	148.64	45*330*1353	149	30MnB HEAT TREATED
112-80-00016							30MnB HEAT TREATED
112-83-00017							30MnB HEAT TREATED
112-83-00018							30MnB HEAT TREATED
112-83-00019							30MnB HEAT TREATED
112-946-1510	16*152*370					6.2	30MnB HEAT TREATED
118-7110	19*203*1199	CAT	BACKHOE LOADER	33.8	19*203*1199	33.8	30MnB HEAT TREATED

122-80-00002							30MnB HEAT TREATED
122-80-00013							30MnB HEAT TREATED
122-80-00017							30MnB HEAT TREATED
122-80-00019							30MnB HEAT TREATED
122-9227	25*254*894	CAT		40.49	25*254*894	42	30MnB HEAT TREATED
122-946-1510							30MnB HEAT TREATED
128-2872	19*203*323	CAT		9.2	19*203*323		30MnB HEAT TREATED
128-2873	19*203*265	CAT		7.5	19*203*265		30MnB HEAT TREATED
11G-71-31170	16*160*380	KOMATSU				7	30MnB HEAT TREATED
12F-70-31251	16*160*762	KOMATSU	D31,D40,D60	13.2	16*152*760	14.1	30MnB HEAT TREATED
12F-70-31261	16*160*914	KOMATSU	D31,D37,D40,D41	15.9	16*152*914	16.9	30MnB HEAT TREATED
12F-70-31281	16*160*1219.2	KOMATSU	D31,D37,D40,D41	21.2	16*152*1219	22.5	30MnB HEAT TREATED
130-70-41130	19*203*1350	KOMATSU	D58E-1	37.7	19*203*1350	38.2	30MnB HEAT TREATED
130-70-61170	19*203*1535	KOMATSU	D50,D53,D58	43.4	19*203*1535	43.4	30MnB HEAT TREATED
130-920-2180	19*203*1199	KOMATSU	D50,D53,D58,D65	33.5	19*203*1199	33.5	30MnB HEAT TREATED
130-Z20-1510	19*203*1255	KOMATSU	D58E-1,D58P-1	35	19*203*1255	36	30MnB HEAT TREATED
132-1033	35*170*496	CAT				20.65	30MnB HEAT TREATED
132-1035	35*225*280	CAT		14.8	35*225*280	15	30MnB HEAT TREATED
132-1037	35*265*280	CAT		17.5	35*265*280	17.5	30MnB HEAT TREATED
132-4715	35*278*305	CAT				16.5	30MnB HEAT TREATED
134-72-61410	19*203*1350	KOMATSU	D61	37.6	19*203*1350	37.6	30MnB HEAT TREATED
134-72-61420	19*203*1255	KOMATSU	D61	35	19*203*1255	35	30MnB HEAT TREATED
135-6537	25*280*1108	CAT		2		58.4	30MnB HEAT TREATED
135-9294	40*300*330	CAT		30.8	40*300*330	30.8	30MnB HEAT TREATED
135-9295	40*315*330	CAT		32.3	40*315*330	32.3	30MnB HEAT TREATED
135-9296	40*315*330	CAT		32.3	40*315*330	32.3	30MnB HEAT TREATED
135-9647	30*265*360	CAT	966	18.8	30*265*360	18.8	30MnB HEAT TREATED
135-9648	30*210*360	CAT		14.9	30*210*360	14.9	30MnB HEAT TREATED

135-9649	30*265*360	CAT		18.8	30*265*360	18.8	30MnB HEAT TREATED
138-0865	40*344*482	CAT		47.6	40*344*482		30MnB HEAT TREATED
138-0866	40*354*482	CAT		50	40*354*482		30MnB HEAT TREATED
138-0867	40*354*482	CAT		50	40*354*482		30MnB HEAT TREATED
138-6470	35*312*482	CAT		40	35*312*482		30MnB HEAT TREATED
138-6471	35*323*482	CAT		41	35*323*482		30MnB HEAT TREATED
138-6472	35*323*482	CAT		41	35*323*482		30MnB HEAT TREATED
139-9230	30*360*1280	CAT LOADER	962,950	96.4	30*360*1285	101.5	30MnB HEAT TREATED
140-0983	16*203*914	CAT				21	30MnB HEAT TREATED
140-2187	16*165*1008	CAT				18.5	30MnB HEAT TREATED
140-6862	35*256*360	CAT		21.8	35*256*360		30MnB HEAT TREATED
140-6863	35*265*360	CAT		22.6	35*265*360		30MnB HEAT TREATED
140-6864	35*265*360	CAT		22.6	35*265*360		30MnB HEAT TREATED
140-6865		CAT					30MnB HEAT TREATED
140-6866	35*210*360	CAT		17.5	35*210*360		30MnB HEAT TREATED
140-6867	35*240*360	CAT		19.8	35*240*360		30MnB HEAT TREATED
140-6868	35*270*360	CAT		23	35*270*360		30MnB HEAT TREATED
140-6869	35*253*360	CAT		20.9	35*253*360		30MnB HEAT TREATED
140-6870	35*293*360	CAT		25	35*293*360		30MnB HEAT TREATED
140-7601	30*360*292	CAT		21.6	30*360*292	21.6	30MnB HEAT TREATED
140-80-00001	19*203*730	KOMATSU		NO DATA	NO DATA	20.4	30MnB HEAT TREATED
140-80-00006							
144-70-11131	19*203*1660	KOMATSU	D60,D65A,D65P-8	47	19*203*1660	47	30MnB HEAT TREATED
144-920-1120	19*203*1382	KOMATSU	D60A,D65A-8	38.6	19*203*1383	40	30MnB HEAT TREATED
14X-71-11310	19*203*1383	KOMATSU				40	30MnB HEAT TREATED
154-70-11313	25*254*1156	KOMATSU	D80,D85	54.9	25*254*1157	54.5	30MnB HEAT TREATED
154-70-11314	25*254*1156			54.9	25*254*1157	54.5	30MnB HEAT TREATED
154-71-41390	25*254*850					39.2	30MnB HEAT TREATED
154-81-11190	25*254*838	KOMATSU	D80,D85	39.7	25*254*838	39.5	30MnB HEAT TREATED

154-81-11191	25*254*838	KOMATSU	D80,D83	39.6	25*254*838	39.5	30MnB HEAT TREATED
156-82-00001	25*254*844	KOMATSU		NO DATA	NO DATA	40	30MnB HEAT TREATED
171-82-00001	25*254*330					13.6	30MnB HEAT TREATED
171-82-00002	25*254*804					38.1	30MnB HEAT TREATED
171-82-00003	25*254*330					13.6	30MnB HEAT TREATED
175-70-21115	25*254*1397	KOMATSU	D155	66	25*254*1397	66	30MnB HEAT TREATED
175-70-26310	25*254*1062	KOMATSU	D135A-2,D150A-1,D155A-2	50.2	25*254*1064	50	30MnB HEAT TREATED
17A-71-11351	35*330*764 POINT	KOMATSU	D155	57.7	32*330*761	63	30MnB HEAT TREATED
17A-71-11654	32*330*761	KOMATSU		NO DATA	NO DATA	54	30MnB HEAT TREATED
17A-71-45210	32*330*1064	KOMATSU		82.5	32*330*1064	82.5	30MnB HEAT TREATED
17A-71-45220	35*330*530	KOMATSU				37	30MnB HEAT TREATED
17A-71-45230	40*330*530	KOMATSU				45.1	30MnB HEAT TREATED
17M-71-21550	30*330*1090	KOMATSU	D275A-2	82.5	32*330*1088	77.6	30MnB HEAT TREATED
	35*330*1090					90.5	30MnB HEAT TREATED
	38*330*1091					98.3	30MnB HEAT TREATED
17M-72-21160	30*330*781	KOMATSU		59.2	32*330*781	55.5	30MnB HEAT TREATED
195-70-12492	30*330*1327	KOMATSU	D355	102.7	32*330*1327	97	30MnB HEAT TREATED
195-71-11654	30*330*1064	KOMATSU	D355			77.6	
	35*330*1064	KOMATSU	D355	82.5	32*330*1064	90.5	30MnB HEAT TREATED
195-71-61550	40*406*887	KOMATSU	D375	108	41*406*887	108	30MnB HEAT TREATED
198-71-11181	40*406*1192	KOMATSU	D375,D455	145.1	41*406*1192	145.1	30MnB HEAT TREATED
198-72-11181	40*406*862	KOMATSU	D375A-2	102.2	41*406*862	102.5	30MnB HEAT TREATED
419-904-1121	25*254*1255.8		WA-300	57.1	25*254*1257	58	30MnB HEAT TREATED
421-70-12122	35*225*3050					185	30MnB HEAT TREATED
421-70-12430	35*225*3170					192.1	30MnB HEAT TREATED
421-815-1121	35*330*546					46.5	30MnB HEAT TREATED
421-815-1221	35*330*592					50.4	30MnB HEAT TREATED
421-815-2110	35*330*2070					177	30MnB HEAT TREATED
421-815-2211	30*330*1382		WA-450-3E			118.2	30MnB HEAT TREATED
421-815-2220	30*196*445		WA-450-3E			22.6	30MnB HEAT TREATED
421-825-3210	35*330*1302					111.2	30MnB HEAT TREATED
421-825-3220	35*278*455					32.77	30MnB HEAT TREATED

423-815-1111	35*330*1617					142.86	30MnB HEAT TREATED
423-815-2210	30*330*1249					107	30MnB HEAT TREATED
423-904-1131	25*254*1217.6			56.8	25*254*1218	56.8	30MnB HEAT TREATED
424-70-H2D60	30*330*650	KOMATSU LOADER	WA380	45.5	30*330*650	45.5	30MnB HEAT TREATED
424-815-1211	35*330*1860					156.5	30MnB HEAT TREATED
							30MnB HEAT TREATED
1U0292	25*280*1162	CAT LOADER	CAT936	56.4	25*280*1161	56.4	30MnB HEAT TREATED
1U0295	25*280*1025	CAT LOADER	CAT952,951,941,926,924	49.4	25*280*1025	49.4	30MnB HEAT TREATED
1U0593	30*360*1319	CAT LOADER	CAT970,972,966,960	99.5	30*360*1319	100	30MnB HEAT TREATED
1U0601	30*360*1210	CAT LOADER	CAT950,960	91.1	30*360*1210	96	30MnB HEAT TREATED
1U0761	40*556*265	LOADER END BIT	CAT980,988	43	40*556*265	43	30MnB HEAT TREATED
1U0762	35*406*1406	CAT LOADER	CAT980	148.6	35*406*1406	148.6	30MnB HEAT TREATED
1U1192	19*254*912.8	CAT	D7	31.78	19*254*913	31.8	30MnB HEAT TREATED
1U1909	30*360*1260	CAT LOADER	CAT966,970	94.1	30*360*1260	94.1	30MnB HEAT TREATED
1U2211	19*203*1396	CAT	D5	38.97	19*203*1396	39	30MnB HEAT TREATED
1U2406	30*360*1230.5	CAT LOADER	CAT966	91.9	30*360*1230.5	94.1	30MnB HEAT TREATED
1U4930	35*254*856	CAT	D8	50.8	32*254*856	55.6	30MnB HEAT TREATED
1U4931	32*254*1095	CAT	D8	65.18	32*254*1095	65.5	30MnB HEAT TREATED
3G4282	19*203*1152	CAT	D5,D6	32.19	19*203*1152	32.2	30MnB HEAT TREATED
3G6395	35*200*510	CAT	973,970F,966D,966E,966F,9	25.6	35*200*510	25.6	30MnB HEAT TREATED
3G9306	19*203*884	CAT	D4,D5	20.23	16*203*884	22	30MnB HEAT TREATED
4T2236	25*203*2438	CAT				93.03	30MnB HEAT TREATED
4T2315	19*203*1558	CAT	D5,D6	43.49	19*203*1558	43.5	30MnB HEAT TREATED
4T2887	22*406*1530	CAT SCRAPER	CAT641,632	96.5	22*406*1530	96.5	30MnB HEAT TREATED
4T2895	30*406*1528.6	CAT SCRAPER	CAT641,632	126.4	29*406*1528.6	131	30MnB HEAT TREATED
4T2921	19*254*1063	CAT	D7	36.99	19*254*1063	36.99	30MnB HEAT TREATED
4T2922	19*254*758	CAT	D7	26.38	19*254*758	26.38	30MnB HEAT TREATED
4T2923	19*254*1029	CAT	D7	35.78	19*254*1029	35.78	30MnB HEAT TREATED
4T2945	19*254*708	CAT	D7	24.85	19*254*708	25	30MnB HEAT TREATED
4T2948	19*254*1063	CAT	D7	37.34	19*254*1063	38	30MnB HEAT TREATED
4T2949	19*254*1520	CAT	D7	53	19*254*1520	53	30MnB HEAT TREATED
4T2952/SJ6839	19*254*802	CAT	D6,D7	28.2	19*254*802	28.2	30MnB HEAT TREATED
4T2973	16*203*860	CAT	D4	19.73	16*203*860	20.2	30MnB HEAT TREATED
4T2974	16*203*808	CAT	D4	18.58	16*203*808	18.6	30MnB HEAT TREATED
4T2981	16*203*2334	CAT	D4	53.14	16*203*2334	53.14	30MnB HEAT TREATED

4T2985	25*254*802	CAT	D6,D7	36.75	25*254*802	37.7	30MnB HEAT TREATED
4T2988	25*254*1034	CAT	D8S,8A	46.82	25*254*1034	48.6	30MnB HEAT TREATED
4T2989/5J6849	25*254*1063	CAT	D7A	48.67	25*254*1063	50	30MnB HEAT TREATED
4T2992	25*254*758	CAT	D7	34.35	25*254*758	35.6	30MnB HEAT TREATED
4T2993	25*254*1063	CAT	D7	48.18	25*254*1063	49.25	30MnB HEAT TREATED
4T2994	25*254*1215	CAT	D8A	55.06	25*254*1215	57.1	30MnB HEAT TREATED
4T3004	19*203*1440	CAT	D5	40.22	19*203*1440	40.8	30MnB HEAT TREATED
4T3007	19*203*1828	CAT	GRADER BLADE	51.1	19*203*1828	51	30MnB HEAT TREATED
4T3008	19*203*1164	CAT		32.32	19*203*1164	32.32	30MnB HEAT TREATED
4T3009/6J1406	19*203*1521	CAT	D6A	42.44	19*203*1521	43	30MnB HEAT TREATED
4T3010	19*203*657	CAT	D6	18.36	19*203*657	18.5	30MnB HEAT TREATED
4T3011	19*203*1619	CAT	D6	45.15	19*203*1619	45.2	30MnB HEAT TREATED
4T3012				41.76	19*203*1497	42	30MnB HEAT TREATED
4T3013	19*203*1010	CAT	D5,D6	28.15	19*203*1010	28.2	30MnB HEAT TREATED
4T3014			D5	62.37	19*203*2231		30MnB HEAT TREATED
4T3015	30*256*360	LOADER END BIT	950,973,980	18.6	30*256*360	18.6	30MnB HEAT TREATED
4T3020	19*203*860	CAT	D5,D6	23.82	19*203*860	23.82	30MnB HEAT TREATED
4T3028	19*203*674	CAT		18.88	19*203*674	19	30MnB HEAT TREATED
4T3043	19*203*290	CAT				8.4	30MnB HEAT TREATED
4T3044	19*203*290	CAT				8.4	30MnB HEAT TREATED
4T3418	25*254*1534	CAT	D8	69.54	25*254*1534	70	30MnB HEAT TREATED
4T3420	25*254*818	CAT	D7	37.15	25*254*818	37.2	30MnB HEAT TREATED
4T3422	25*254*1095	CAT	D8	49.67	25*254*1095	51.5	30MnB HEAT TREATED
4T3423	25*254*856	CAT	D8	38.72	25*254*856	39	30MnB HEAT TREATED
4T3444	30*406*1580	CAT SCRAPER	CAT611,631,637	130.8	29*406*1580	135.5	30MnB HEAT TREATED
4T5318	19*254*894	CAT	D7	31.1	19*254*894	31.5	30MnB HEAT TREATED
4T6230	16*165*863.6	CAT	D3,D4	15	16*165*863.6	16	30MnB HEAT TREATED
4T6378	30*330*900	CAT	D8,D9	61.6	28.5*330*900	65	30MnB HEAT TREATED
4T6381	30*330*1354	CAT	D8,D9	92.68	28.5*330*1354	97.6	30MnB HEAT TREATED
4T6386	30*330*1040	CAT	D9	71.17	28.5*330*1040	75.7	30MnB HEAT TREATED
4T6513		CAT					
4T6514	25*254*1558	CAT		70.66	25*254*1558	71.4	30MnB HEAT TREATED
4T6515	25*254*1773	CAT	D835,834S,826	80.29	25*254*1773	83.3	30MnB HEAT TREATED
4T6531	25*254*1520	CAT	D8	68.89	25*254*1520	69	30MnB HEAT TREATED
4T6532	25*254*910	CAT	D8	43.3	25*254*910	44.5	30MnB HEAT TREATED

4T6568	25*406*1429	CAT SCRAPER	CAT621,627	90.2	22*406*1429	90.3	30MnB HEAT TREATED
4T6592	35*406*858					91.3	30MnB HEAT TREATED
4T6594	35*406*1542					164.1	30MnB HEAT TREATED
4T6612	25*330*748	CAT SCRAPER	CAT621,627	39	22*330*748	44.3	30MnB HEAT TREATED
4T6613		CAT SCRAPER	CAT613	29	22*330*560		30MnB HEAT TREATED
4T6614		CAT SCRAPER	CAT641,637,632,631	46.9	22*330*900		30MnB HEAT TREATED
4T6648	30*305*1520	CAT		NO DATA	NO DATA	99	30MnB HEAT TREATED
4T6659	19*203*1052	CAT	D4,D5,D6	29.35	19*203*1052	29.4	30MnB HEAT TREATED
4T6694	25*225*280	CAT	SIDE EDGE	10.6	25*225*280	11	30MnB HEAT TREATED
4T6695	25*265*280	CAT	SIDE EDGE	12.5	25*265*280	12.5	30MnB HEAT TREATED
4T6696		CAT	SIDE EDGE				30MnB HEAT TREATED
4T6697	30*210*360	CAT	SIDE EDGE	14.9	30*210*360	15	30MnB HEAT TREATED
4T6698	30*240*360	CAT	SIDE EDGE	17	30*240*360	17	30MnB HEAT TREATED
4T6699	30*270*360	CAT	SIDE EDGE	19.7	30*270*360	23	30MnB HEAT TREATED
4T-6700	30*290*360	CAT	988B,980C,	21.2	30*290*360	21.5	30MnB HEAT TREATED
4T8077	16*203*2382	CAT				54.75	30MnB HEAT TREATED
4T8091	25*160*342	CAT				10	30MnB HEAT TREATED
4T8101	30*170*496	CAT	950G			19	30MnB HEAT TREATED
4T8317	35*254*2438	CAT				160.4	30MnB HEAT TREATED
4T8796	19*254*1238	CAT				43.4	30MnB HEAT TREATED
4T8799	25*254*998.4	CAT		NO DATA	NO DATA	45.4	30MnB HEAT TREATED
4T8940	16*203*1193.8	CAT	D4,D5	27.33	16*203*1193.8	28	30MnB HEAT TREATED
4T9585/6Y5540		CAT					30MnB HEAT TREATED
4T9586	30*330*1695	CAT	D8	116.09	28.5*330*1695	122.2	30MnB HEAT TREATED
4T9587/6Y5540	30*330*802	CAT	D8,D9	54.8	29*330*802	56.7	30MnB HEAT TREATED
4T9836	35*330*1695	CAT	D8	143.75	35*330*1695	144	30MnB HEAT TREATED
5J6888	19*254*1063	CAT	D6			38.2	30MnB HEAT TREATED
	25*254*1063	CAT	D7	37.34	19*254*1063	49.3	30MnB HEAT TREATED
5V7276	25*245*2616	CAT		114.8	25*245*2616	123.3	30MnB HEAT TREATED
5V7423	25*245*2439	CAT				106.9	30MnB HEAT TREATED
6J1406		CAT			19*203*1521	42.5	30MnB HEAT TREATED
6J7116	25*254*1533	CAT	D8R,8S	69.54	25*254*1534	72.1	30MnB HEAT TREATED
6W2985		CAT					30MnB HEAT TREATED
6W2987		CAT					30MnB HEAT TREATED
6W2989	32*282*2840	CAT				185	30MnB HEAT TREATED



6W2990	30*282*2856	CAT				175.1	30MnB HEAT TREATED
6Y3840	25*254*1225.6	CAT		57	25*254*1225.6	58	30MnB HEAT TREATED
6Y5539	30*330*1787	CAT	D9	125.4	29*330*1787	130	30MnB HEAT TREATED
6Y5540/4T9587	30*330*802	CAT	D8,D9	54.8	29*330*802	54.8	30MnB HEAT TREATED
7J2959	40*330*900	CAT	D9	89.84	41*330*900	88	30MnB HEAT TREATED
7J2980	40*330*1040	CAT	D9	103.79	41*330*1040	110.9	30MnB HEAT TREATED
7T3495	25*203*2438.4	CAT				91.6	30MnB HEAT TREATED
7T5701		CAT	D9	191.99	35*330*2265		30MnB HEAT TREATED
7T5702	35*330*1787.4	CAT	D9SU	151.51	35*330*1788	155	30MnB HEAT TREATED
7T6589	25*280*1095	CAT			25*280*1095	58.3	30MnB HEAT TREATED
7T6592		CAT	D7	26.87	25*280*567		30MnB HEAT TREATED
7T6678	25*280*894	CAT	D7	42.43	25*280*894	47.6	30MnB HEAT TREATED
7T6936	25*280*908	CAT	D7	43.12	25*280*908	43.12	30MnB HEAT TREATED
7T9125	35*330*803	CAT	D9SU,8SU	68.17	35*330*803	68.2	30MnB HEAT TREATED
	30*330*803	CAT			30*330*803	58.5	30MnB HEAT TREATED
7T9126	35*330*1353.2	CAT	D9U,8SU	114.76	35*330*1354	115	30MnB HEAT TREATED
7T9127	35*330*824.1 POINT	CAT	D8U	70	35*330*824		30MnB HEAT TREATED
7T9976		CAT	D6	39.6	25*203*1053		30MnB HEAT TREATED
7T9977	25*203*1019	CAT	D6	38.3	25*203*1019	38.3	30MnB HEAT TREATED
7T9978	25*203*658	CAT	D6	24.8	25*203*658	24.8	30MnB HEAT TREATED
7V1490	40*300*3033	CAT				246	30MnB HEAT TREATED
7V6844	40*300*2914	CAT				260.2	B-HARD360 OR 45#
8294271	19*203*912					26.1	30MnB HEAT TREATED
8E2085	60*406*992	CAT	D10SU, 10U	179.18	60*406*992	180	30MnB HEAT TREATED
8E2086	60*406*859	CAT	D10SU, 10U	155.34	60*406*859	155.5	30MnB HEAT TREATED
8E2087	60*406*848					153.5	30MnB HEAT TREATED
8E4567	25*280*1102	CAT LOADER	CAT928,926	53.2	25*280*1102	53.2	30MnB HEAT TREATED
8E-4569	25*247*280	CAT	IT28,IT26,IT18	11.6	25*247*280	13	30MnB HEAT TREATED
8J1489		CAT	D4		19*203*808	22.3	30MnB HEAT TREATED
				16*203*808	18.8	30MnB HEAT TREATED	
8J1490		CAT	D4		19*203*860	24	30MnB HEAT TREATED
				16*203*860	20	30MnB HEAT TREATED	
8J9668	25*254*1215	CAT	D8	55.06	25*254*1215	56.2	30MnB HEAT TREATED
8K8161		CAT			25*245*2438	121	30MnB HEAT TREATED

8K9754		CAT	CAT966		32*267*2921	181.3	B-HARD360 OR 45#
9K1619	45*305*3270	CAT				345	B-HARD360 OR 45#
9J4369	35*406*1580	CAT SCRAPER	CAT637,631	162	35*406*1580	162	30MnB HEAT TREATED
9J5899	40*406*1580	CAT SCRAPER	CAT637,631	190.8	41*406*1580	190.8	30MnB HEAT TREATED
9R5313	20*150*2406			52	20*150*1396	58	30MnB HEAT TREATED
9U8057	19*203*627	CAT	D5,D6	17.5	19*203*627	17.5	30MnB HEAT TREATED
9V0169	35*607*2870	CAT LOADER	CAT966		38*606*2870		30MnB HEAT TREATED
9V0170	40*580*3085	CAT LOADER	CAT966		41*580*3085		30MnB HEAT TREATED
9V6573	30*282*2735	CAT LOADER				158	B-HARD360 OR 45#
9V6574	45*305*3314	CAT LOADER	CAT980	360	45*305*3315	361	B-HARD360 OR 45#
9V6575		CAT LOADER			40*300*3032	271	B-HARD360 OR 45#
9W1375	35*406*1524	CAT LOADER	CAT988	161.3	35*406*1525	161.5	30MnB HEAT TREATED
9W1878	19*254*1227.3	CAT	D6SU	43.18	19*254*1229	47	30MnB HEAT TREATED
9W3927	45*330*800	CAT	D9SU	88.03	45*330*800	88.5	30MnB HEAT TREATED
9W4397	35*330*2164	CAT	D8	183.54	35*330*2164	184	30MnB HEAT TREATED
9W4398	35*330*800	CAT	D8SU	67.91	35*330*800	68	30MnB HEAT TREATED
9W4493	60*406*1024	CAT	D11	182.29	60*406*1024	182.3	30MnB HEAT TREATED
9W4494	60*406*1020	CAT	D11	181.55	60*406*1020	182	30MnB HEAT TREATED
9W4500	35*330*1040	CAT	D9SU	88.12	35*330*1040	88.5	30MnB HEAT TREATED
9W4502	35*330*1223	CAT	D9SU	103.7	35*330*1223	104	30MnB HEAT TREATED
9W4508	40*330*1223	CAT	D9	122.15	40*330*1223	131.4	30MnB HEAT TREATED
9W4902	35*406*908	CAT SCRAPER	CAT651,657	92.9	35*406*908	92.9	30MnB HEAT TREATED
9W5232	30*330*825	CAT	D8	56.59	28.5*330*825	60	30MnB HEAT TREATED
9W5432	30*330*1241	CAT	D8	85.01	28.5*330*1241	85.5	30MnB HEAT TREATED
9W6092	35*330*900	CAT	D8U,9U	76.28	35*330*900	76.5	30MnB HEAT TREATED
9W6608	35*406*859			89.3	35*406*859	90	30MnB HEAT TREATED
9W6609	35*406*992			103.02	35*406*992	103	30MnB HEAT TREATED
9W6656	45*406*995	CAT	D10SU,10U	133.91	45*406*995	134	30MnB HEAT TREATED
9W6657	45*406*859	CAT	D10SU,10U	115.73	45*406*859	116	30MnB HEAT TREATED
9W7043	45*330*1787	CAT	D9SU	196.39	45*330*1788	196.5	30MnB HEAT TREATED
9W8215	19*203*1130	CAT BACKHOE LO	CAT428,438	31.8	19*203*1130	31.8	30MnB HEAT TREATED
9W9098	35*330*1240	CAT	D8	105.18	35*330*1240	105.2	30MnB HEAT TREATED
9W9702	45*406*908	CAT SCRAPER	CAT651,657	120.4	45*406*908	120.4	30MnB HEAT TREATED
U17519							
U18064							

U18400							
U18197							
U17689							

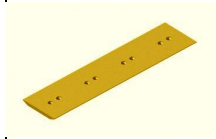

## LOADER CUTTING EDGES (装载机刀片)

PART NUMBER	DESCRIPTION(MM)	BRAND	MODEL	IRWT	IR DES	U' WT(KG)	MATERIAL
P45161501800	16*150*1800					31.2	30MnB HEAT TREATED
P45161502500	16*150*2500					43.33	30MnB HEAT TREATED
P45161503000	16*150*3000					52	30MnB HEAT TREATED
P45201501800	20*150*1800					39	30MnB HEAT TREATED
P45201502500	20*150*2500					54.17	30MnB HEAT TREATED
P45201503000	20*150*3000					65	30MnB HEAT TREATED
P45202002400	20*200*2400					69.33	30MnB HEAT TREATED
P45202002500	20*200*2500					72.22	30MnB HEAT TREATED
P45202003000	20*200*3000					86.66	30MnB HEAT TREATED