

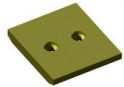

GUANNAN CUTTING EDGE



LOADER END BITS

PART NUMBER	DESCRIPTION(MM)	BRAND	MODEL	IRWT	IR DES	U' WT(KG)	MATERIAL
100-4043	45*265*556	CAT	CAT980	48.6	45*265*556	48.6	30MnB HEAT TREATED
100-6668	30*360*1399.5	CAT LOADER	CAT 972	104.7	30*360*1399.5	111	30MnB HEAT TREATED
107-3746	25*280*1179	CAT LOADER	CAT 938	57	25*280*1179	57	30MnB HEAT TREATED
109-9212	35*406*1450	CAT LOADER	CAT 980	153.3	35*406*1450	153.3	30MnB HEAT TREATED
118-7110	19*203*1199	CAT	BACKHOE LOADER	33.8	19*203*1199	33.8	30MnB HEAT TREATED
139-9230	30*360*1280	CAT LOADER	962,950	96.4	30*360*1285	101.5	30MnB HEAT TREATED
424-70-H2D60	30*330*650	KOMATSU LOADE	WA380	45.5	30*330*650	45.5	30MnB HEAT TREATED
100-6664	30*253*360	CAT		17.9	30*253*360		30MnB HEAT TREATED
100-6666	30*293*359	CAT	970	21.4	30*293*359	23.4	30MnB HEAT TREATED
101-9435	38*346*482	CAT	988F	47.5	40*342*482	45.3	30MnB HEAT TREATED
101-9436	38*354*482	CAT	988F	50	40*354*482	46.1	30MnB HEAT TREATED
101-9437	38*354*482	CAT	988F	50	40*354*482	46.1	30MnB HEAT TREATED
106-9290	35*227*510	CAT				28.5	30MnB HEAT TREATED
107-3490	45	CAT		50	45*312*482		30MnB HEAT TREATED
107-3528	45*354*482	CAT				56.3	30MnB HEAT TREATED
107-3537	45*354*482	CAT				56.3	30MnB HEAT TREATED
109-9019	30*315*360	CAT		22.3	30*315*360		30MnB HEAT TREATED
128-2872	19*203*323	CAT		9.2	19*203*323		30MnB HEAT TREATED
128-2873	19*203*265	CAT		7.5	19*203*265		30MnB HEAT TREATED

132-1035	35*225*280	CAT		14.8	35*225*280		30MnB HEAT TREATED
132-1037	35*265*280	CAT		17.5	35*265*280		30MnB HEAT TREATED
132-4715		CAT					30MnB HEAT TREATED
135-9294	40*300*330	CAT		30.8	40*300*330	30.8	30MnB HEAT TREATED
135-9295	40*315*330	CAT		32.3	40*315*330		30MnB HEAT TREATED
135-9296	40*315*330	CAT		32.3	40*315*330	32.3	30MnB HEAT TREATED
135-9647	30*265*360	CAT	966	18.8	30*265*360		30MnB HEAT TREATED
135-9647/49	30*360*355	CAT		18.8	30*265*360		30MnB HEAT TREATED
135-9648	30*360*210	CAT		14.9	30*210*360		30MnB HEAT TREATED
135-9648	30*210*360	CAT		14.9	30*210*360		30MnB HEAT TREATED
135-9649	30*265*360	CAT		18.8	30*265*360		30MnB HEAT TREATED
138-0865	40*344*482	CAT		47.6	40*344*482		30MnB HEAT TREATED
138-0866	40*354*482	CAT		50	40*354*482		30MnB HEAT TREATED
138-0867	40*354*482	CAT		50	40*354*482		30MnB HEAT TREATED
138-6470	35*312*482	CAT		40	35*312*482		30MnB HEAT TREATED
138-6471	35*323*482	CAT		41	35*323*482		30MnB HEAT TREATED
138-6472	35*323*482	CAT		41	35*323*482		30MnB HEAT TREATED
140-6862	35*256*360	CAT		21.8	35*256*360		30MnB HEAT TREATED
140-6863	35*265*360	CAT		22.6	35*265*360		30MnB HEAT TREATED
140-6864	35*265*360	CAT		22.6	35*265*360		30MnB HEAT TREATED
140-6865		CAT					30MnB HEAT TREATED
140-6866	35*210*360	CAT		17.5	35*210*360		30MnB HEAT TREATED
140-6867	35*240*360	CAT		19.8	35*240*360		30MnB HEAT TREATED
140-6868	35*270*360	CAT		23	35*270*360		30MnB HEAT TREATED
140-6869	35*253*360	CAT		20.9	35*253*360		30MnB HEAT TREATED
140-6870	35*293*360	CAT		25	35*293*360		30MnB HEAT TREATED
140-7601	30*360*292	CAT		21.6	30*360*292	21.6	30MnB HEAT TREATED
4T3015	30*360*256	CAT		18.6	30*256*360		30MnB HEAT TREATED
4T6691	25*175*280	CAT	951,943,941	8.2	25*175*280	8.2	30MnB HEAT TREATED
4T6692	25*195*280	CAT	963,955,953	9.1	25*195*280	9.5	30MnB HEAT TREATED
4T6693,132-1036	25*210*280	CAT	963,930	9.8	25*210*280	9.8	30MnB HEAT TREATED
4T6694	25*225*280	CAT	953,951,941,920,916,IT28,I	10.6	25*225*280	10.9	30MnB HEAT TREATED
4T6694,132-1035	25*225*280	CAT	953.951.941.920.916.IT28,I	10.6	25*225*280	11.7	30MnB HEAT TREATED
4T6695	25*265*280	CAT	950B,950E,950F	12.5	25*265*280	12.9	30MnB HEAT TREATED

4T6696	30*190*360	CAT	977	13.6	30*190*360	14.1	30MnB HEAT TREATED
4T6697	30*210*360	CAT	973,966D,966E	14.9	30*210*360	15.7	30MnB HEAT TREATED
4T6698	30*240*360	CAT	973,966D,966E	17	30*240*360	19.2	30MnB HEAT TREATED
4T6699	30*270*360	CAT	970,966D,966E	19.7	30*270*360	19.7	30MnB HEAT TREATED
4T6700	30*290*360	CAT	988B,980C,	21.2	30*290*360	21.5	30MnB HEAT TREATED
4T7139	30*305*360	CAT		22.3	30*305*360		30MnB HEAT TREATED
4T7139	30*305*360	CAT		22.3	30*305*360		30MnB HEAT TREATED
4T7140	30*305*360	CAT		22.3	30*305*360		30MnB HEAT TREATED
4T8091	25*160*342	CAT	,943,941,936,930,926,920,9	9.4	25*160*342	10	30MnB HEAT TREATED
4T8101	30*170*496	CAT	963,955,950.950B,950E	17.5	30*170*496	17.5	30MnB HEAT TREATED
4T9123,132-1039	30*265*360	CAT		19.4	30*265*360		30MnB HEAT TREATED
4T9124,132-1040	30*265*360	CAT		19.4	30*265*360		30MnB HEAT TREATED
9W5730	35*323*483	CAT	988B	41	35*323*483	41	30MnB HEAT TREATED
9W5734	35*312*483	CAT	988B	40	35*312*483	40	30MnB HEAT TREATED
9W5737	35*323*483	CAT	988B	41	35*323*483	41	30MnB HEAT TREATED
9W8367	35*367*483	CAT		47	35*367*483		30MnB HEAT TREATED
9W8368	35*367*483	CAT		47	35*367*483		30MnB HEAT TREATED
SEG-25	25*280*265	CAT				14.5	30MnB HEAT TREATED
SEG-30	30*360*300	CAT				25.5	30MnB HEAT TREATED
SUB-30	30*360*1400	CAT				118.7	30MnB HEAT TREATED